

SIDE SEWER REQUIREMENTS

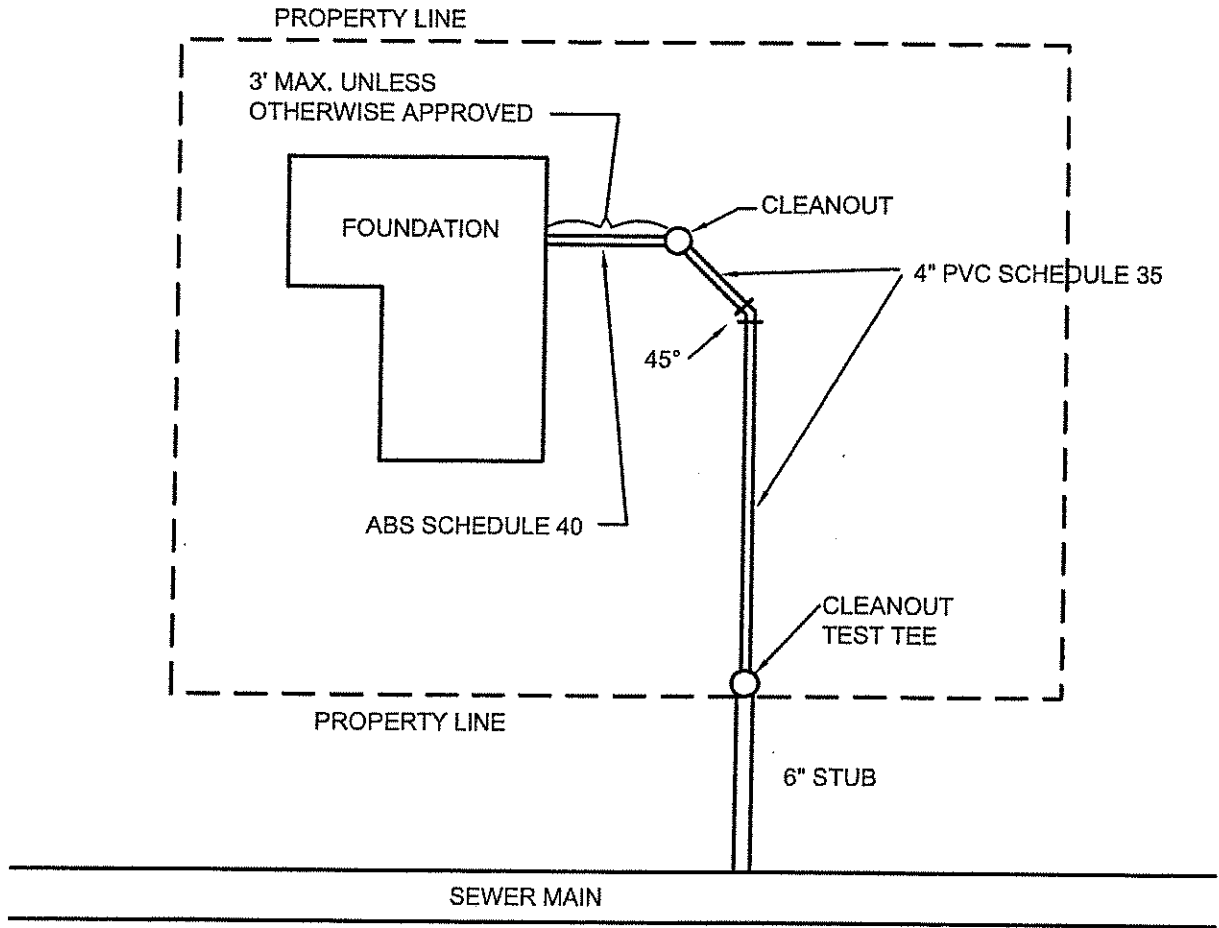

W:\1999\19058-WD 10 Water Comp Plan\WD10 STANDARD\Side sewer require.dwg, 10/22/2002 01:38:36 PM, RDN

Wilson Engineering
CONSULTING ENGINEERS & SURVEYORS

805 807001 STREET
BELLINGHAM WA 98225
(360) 733-6100
FAX: (360) 647-9961

WHEATCOM COUNTY WATER DISTRICT NO. 10
WHEATCOM COUNTY WASHINGTON
EXHIBIT 6.2-1
SIDE SEWER INSTALLATION REQUIREMENT DETAIL

DATE	1
May 2000	
SCALE	1"
N.T.S.	
JOB NUMBER	1
89000	

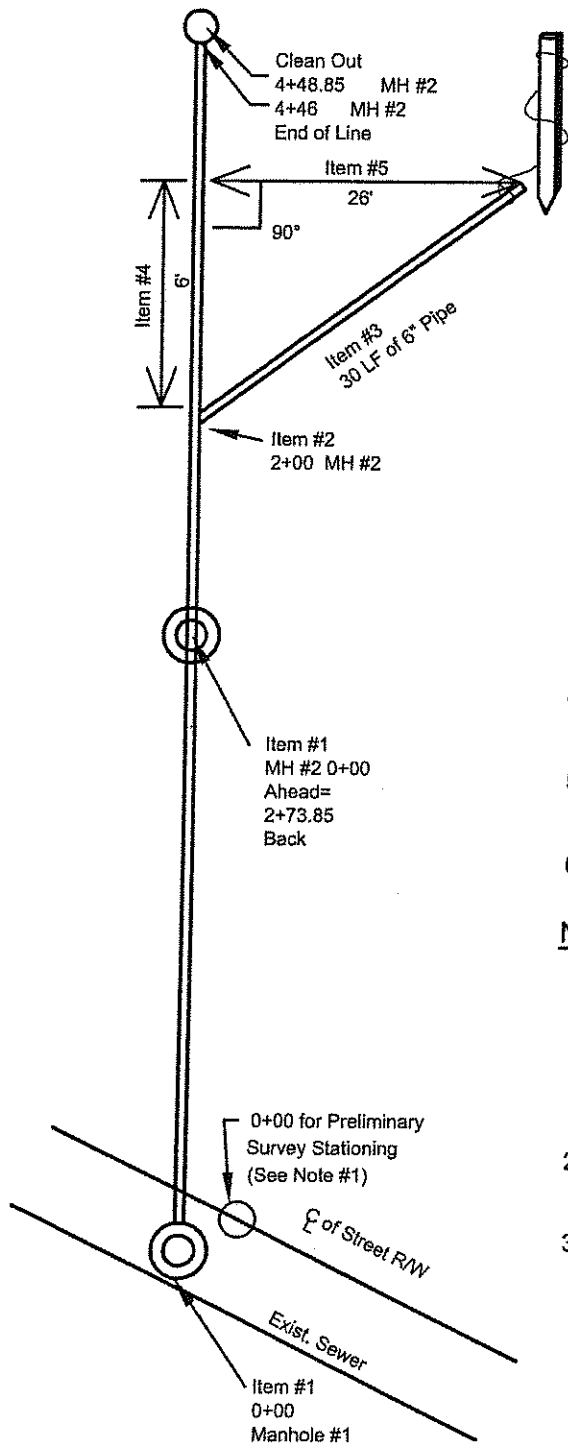

Item No.

1. 0+00 stationing is started at each manhole.
2. Stationing of side sewer services on the sewer main from the back-station manhole.
3. Measure distance, lineal feet and size of pipe.
4. Measure distance of main line from the tee to where the end equals 90° from the main line.
5. Measure distance from this point (Item #4) to the end of the stub (distance out at 90°.)
6. Measure depth of side sewer at end.

Note:

1. Often the preliminary survey begins stationing at a street intersection moment and is not equated at the time of construction. For the purpose of as-built records, the beginning manhole (new or existing) will be 0+00 (see Item #1 above).
2. The end of each side sewer must be tied out to corresponding property corners.
3. The location of all utilities within easements or R-O-W must be shown. This shall include distances to the utilities from the easement or R-O-W line.

Wilson Engineering
CONSULTING ENGINEERS & SURVEYORS

695 BOPART STREET
BELLINGHAM WA 98225
(360) 733-6100
FAX: (360) 647-9061

WHEATCOM COUNTY WATER DISTRICT NO. 10
WHEATCOM COUNTY WASHINGTON
EXHIBIT 2-2
TYPICAL SEWER PROJECT AS-BUILT DRAWING

DATE	May 2000	SHEET	1
SCALE	N.T.S.	OF	
DWG NUMBER	99008		1